

DRAWING

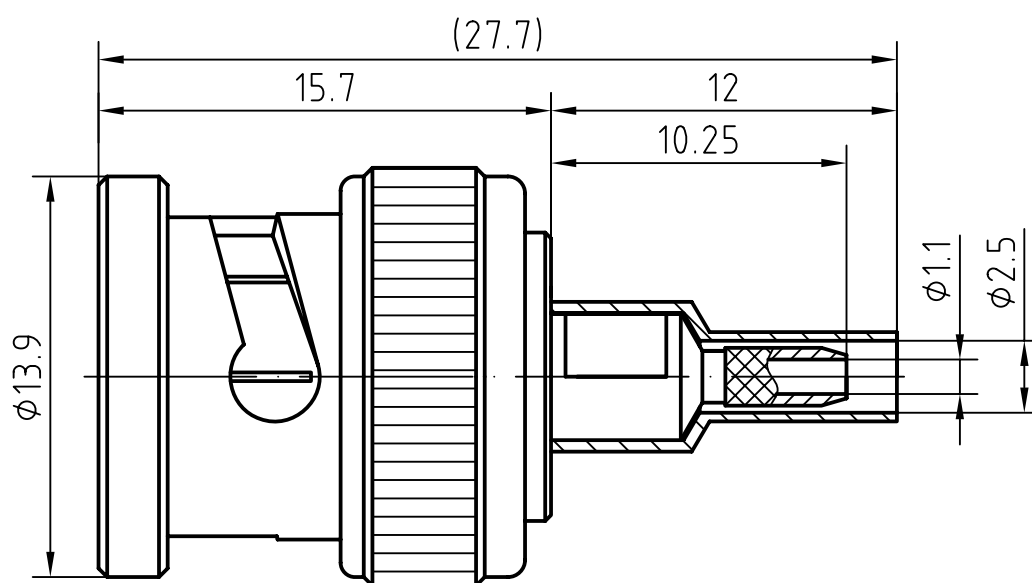

CABLE(RG178/U,RG196/U)

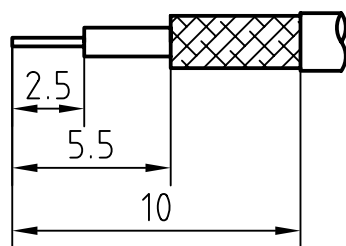

5	1	Gasket	Silicone rubber	
4	1	Coupling nut	Brass/Nickel plated	Nickel 5um over Copper 2um
3	1	Body	Brass/Neckel plated	Nickel 5um over Copper 2um
2	1	Insulator	PTFE	
1	1	Center contact	Brass/Gold plated	Gold 0.2um over Nickel 2um
Itemref	Quantity	Title/Name, designation, material, dimension etc		Article No./Reference

Designed by

Checked by

Approved by - date

File name

Date

Scale

B-111MQA

Edition

Sheet

# CHARACTERISTICS

DESCRIPTION: BNC Type male connector

Electrical characteristics:

Impedance:	50 ohm
Frequency range:	DC to 4 GHz
VSWR:	$\leq 1.08 + 0.05 \times f[\text{GHz}]$
Insertion loss:	$\leq 0.08 \times \sqrt{f}[\text{GHz}] \text{ dB}$
Insulation resistance:	$\geq 5000 \text{ M}\Omega$
Test voltage:	1500 V rms
Working voltage:	400 V rms
Contact resistance:	
1). Centre contact:	1.5 m $\Omega$
2). Outer conductor:	1.0 m $\Omega$
Power handling (at 20 °C, sea level, VSWR 1.0):	80 W @ 2 GHz

Environmental data:

Temperature rating:	-55 ° C to +165 ° C
52/95/EC (RoHS):	Compliant

Mechanical data:

Mating cycles:	$\geq 500$
Center contact captivation:	$\geq 15 \text{ N(axial)}$

Suitable cables:

RG178/U, RG196/U